

Riminese 14th Century, 14th century
Crucifixion



KRESS CATALOGUE NUMBER

K29

IDENTIFIER

3395

ARTIST

Riminese 14th Century, 14th century

NATIONALITY

Italian

DATE

c. 1325 / 30

MEDIUM

tempera and gold leaf on panel

TYPE OF OBJECT

Painting

DIMENSIONS

25.4 x 29.21 cm 10 x 11 1/2 in)

LOCATION

Allentown Art Museum, Allentown, Pennsylvania

HISTORICAL ATTRIBUTION

Baronzio, Giovanni, active c. 1320-1350

PROVENANCE

Vatican Picture Gallery until about 1830/46; Giulio Sterbini [d. 1911], Rome. (Count Alessandro Contini Bonacossi [1878-1955], Rome and Florence); sold to Samuel H. Kress [1863-1955] on 5 October 1927 as Baronzio; gift to the Allentown Art Museum in 1961, no. 1960.02.

ACCESSION NUMBER

1960.002.000

KRESS COLLECTION DIGITAL ARCHIVE

KRESS NUMBER

29

4 ACQUISITIONS

Contini Bonacossi, Alessandro, October 5, 1927

Contini Bonacossi, Alessandro, June 13, 1932

Contini Bonacossi, Alessandro, August 1, 1934

Contini Bonacossi, Alessandro, June 27, 1934

1 DISTRIBUTION

Gift to Allentown Art Museum, May 31, 1946

EXTERNAL LINKS

Related National Gallery of Art Library Image Collections Record

https://library.nga.gov/permalink/01NGA_INST/1p5jkvq/alma991105173804896

9 ARCHIVAL ITEMS



K0029 - Expert opinion by Berenson et al., circa 1920s-1950s



K0029 - Expert opinion by Berenson, circa 1920s-1950s

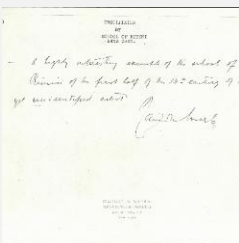

K0029 - Expert opinion by Marle, circa 1920s-1930s

KRESS COLLECTION DIGITAL ARCHIVE

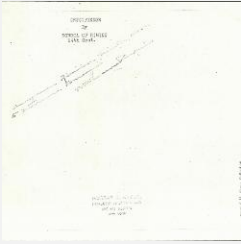

K0029 - Expert opinion by Perkins, circa 1920s-1940s



K0029 - Alan Burroughs report, circa 1930s-1940s



K0029 - Expert opinion by Fiocco, circa 1930s-1940s



K0029 - Photograph, circa 1930s-1960s



K0029 - Expert opinion by Suida et al., 1935

KRESS COLLECTION DIGITAL ARCHIVE



K0029 - Condition and restoration record, circa 1950s-1960s

RECORD LINK

<https://kress.nga.gov/Detail/objects/3395>